



American Thermowell



www.americanthermowell.com

BUILT ON A TRADITION OF EXCEEDING QUALITY AT EVERY STEP.

Revised (08/22/2024)

Restriction Orifice Union

An alternative design to control flow, with a wide range of options

Restriction orifice unions feature a single piece metal orifice plate that fits perfectly into the union seat, eliminating the need for a gasket.

Orifice unions are commonly used in fire pump systems, since they have the ability to handle higher levels of pressure while maintaining a smaller overall pipe size. This also makes them perfect for small bore applications.

Our plates are available with a pressed plate. All our restriction orifice union cups can be bored to specifications based on the customers application. Large order discounts are available, talk to your American Thermowell expert today for complete details.



Features:

- Available with pressure ratings of 3000 and 6000 psig.
- Threaded and socket-weld connections available
- Unions are available in A105 carbon steel or 316 stainless steel, along with other materials
- Available in pipe sizes ranging from 1/8" - 2"
- Union cups also sold separately



Union Cup

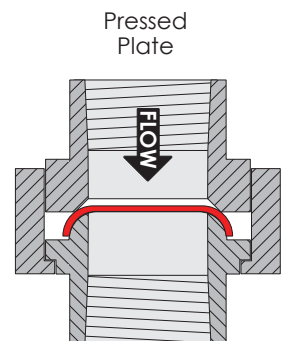



Built on a tradition of exceeding quality at every step

RESTRICTION ORIFICE UNION

Threaded Unions - CL3000#

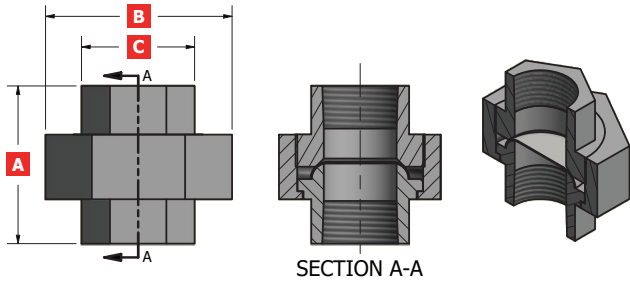

Socket Weld Unions - CL3000#

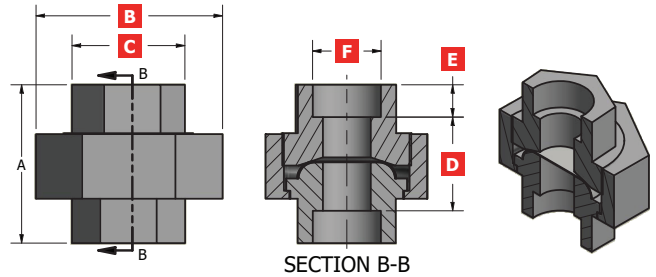

CL3000 Threaded and Socket Weld Unions Dimensions							
Pipe Size	A	B	C	D	E	F	Weight (lbs.)
1/8"	1 11/16"	1 31/64"	53/64"	25/32"	7/16"	0.420-0.430	0.380
1/4"	1 11/16"	1 31/64"	53/64"	25/32"	7/16"	0.555-0.565	0.360
3/8"	1 27/32"	1 11/16"	1"	31/32"	7/16"	0.690-0.700	0.500
1/2"	2	1 15/16"	1 3/16"	1 3/32"	7/16"	0.855-0.865	0.695
3/4"	2 5/16"	2 3/8"	1 15/32"	1 5/32"	9/16"	1.065-1.075	1.175
1"	2 7/16"	2 25/32"	1 25/32"	1 3/8"	9/16"	1.330-1.340	1.640
1 1/4"	2 7/16"	3 23/64"	2 7/32"	1 45/64"	9/16"	1.675-1.685	2.590
1 1/2"	3	3 23/64"	2 35/64"	1 7/8"	9/16"	1.915-1.925	3.410
2"	3 1/2"	4 27/64"	3 1/16"	2 1/16"	11/16"	2.406-2.416	5.120

Material Options: A105 carbon steel or 316 stainless steel

Industries: Any industry that requires flow restriction, including coolants, gases, steam and water.

- Pipe diameter: 1/8" up to 2"
- Seals will not loosen, even under extreme pressure and surges
- Available in threaded and socket-weld connections
- Pressure ratings of 3000 psig. and 6000 psig.
- Plates can be pressed or recessed



Specializing in instrumentation and process control hardware.

- ✓ Thermowells
- ✓ Bleed & Flush Rings
- ✓ Orifice Plates
- ✓ Valves

